

Market Square (COURTYARD LEVEL)

Victoria, British Columbia

2011



| UNIT# | SQ.FT. | TENANT NAME |
|-------|--------|-------------------------------------|
| 5 | 3,694 | Green Cuisine Vegetarian Restaurant |
| 9 | 942 | Canadian Pacific Ballet |
| 13 | 1,435 | Pair-O-Dice Tattoos |
| 17 | 4,100 | Available |
| 27 | 3,529 | Victoria Social Club |
| 39 | 1,635 | Market Square Administration Office |
| 41 | 1,752 | Canadian Pacific Ballet |
| 43 | 1,192 | People Logic Software |
| 45 | 1,172 | Banner Carpets |
| 47 | 1,181 | Pacific Rim College Yoga Studio |
| 49 | 1,170 | Occupied |
| 62 | 1,173 | Angels of Avalon |
| 63 | 1,630 | Beadworld |
| 65 | 591 | Available |
| 69 | 210 | Asahi Sushi |

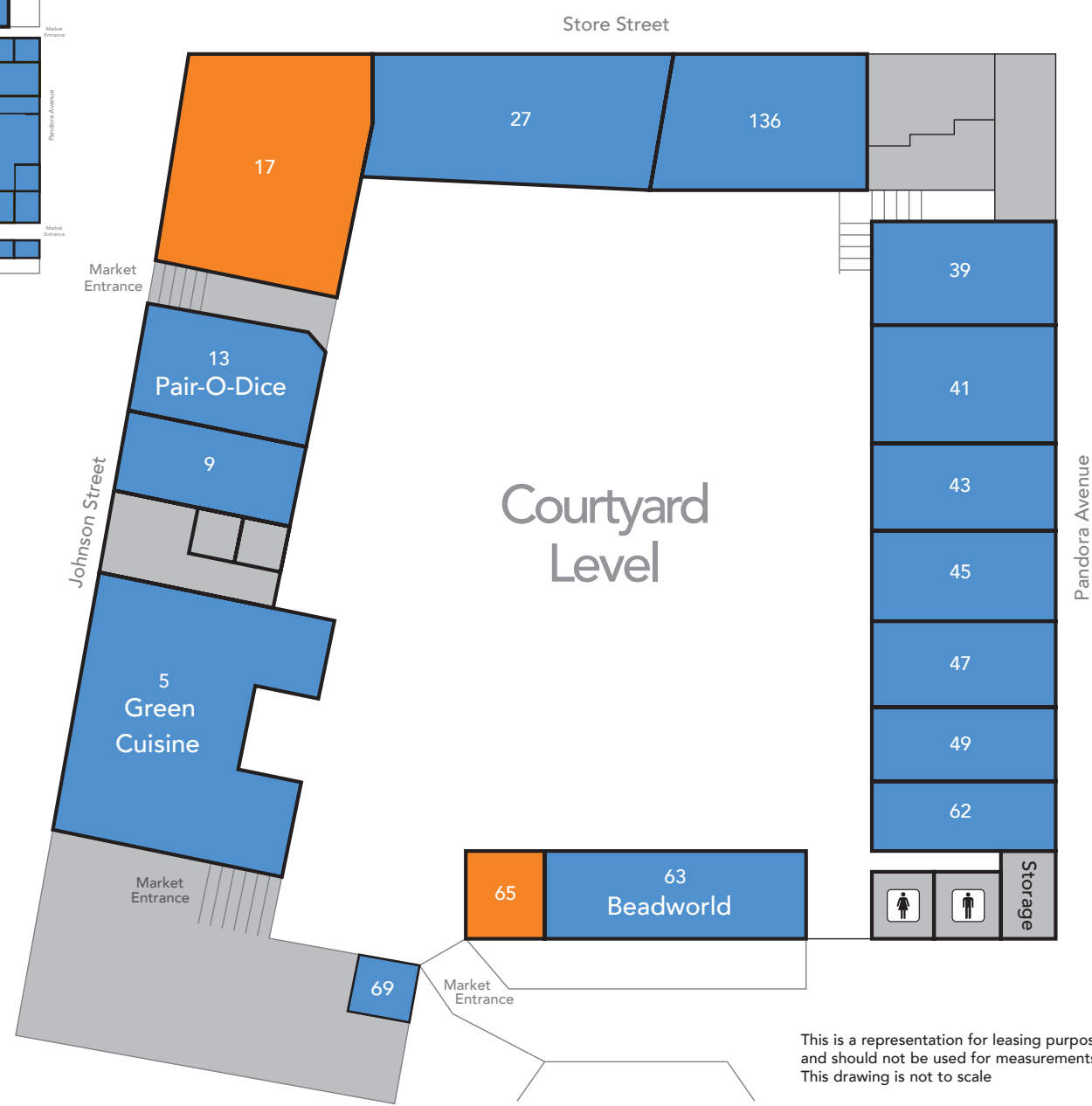

This is a representation for leasing purposes only and should not be used for measurements of any kind. This drawing is not to scale.

Anthem PROPERTIES 

Anthem Properties
 Suite 300 Bentall 5 550 Burrard Street
 Vancouver BC Canada V6C 2B5
 t 604 689 3040 toll free 1 800 926 8436
 f 604 689 5642
www.anthemproperties.com